

Tippmann Ordnance

TG-500 Belt-Fed Lid Kit

Installation & Operation Manual

Scan for installation video



WARNING / LIABILITY STATEMENT

This product is classified as a **dangerous weapon** and is sold by **Tippmann Ordnance** with the understanding that the purchaser assumes **all liability** resulting from unsafe handling or any action that constitutes a violation of applicable laws or regulations.

Tippmann Ordnance shall **not be liable** for personal injury, loss of property, or loss of life resulting from the use of this firearm under any circumstances, including intentional, reckless, negligent, or accidental discharge.

All information contained in this manual is subject to change without notice. Tippmann Ordnance reserves the right to make changes and improvements to its products without incurring any obligation to incorporate such changes into products previously sold.

If you do not accept full responsibility and liability for the use of this firearm, **do not use this product**. By using this firearm, you release Tippmann Ordnance from any and all liability associated with its use.

YOU ARE RESPONSIBLE FOR FIREARM SAFETY

READ THIS MANUAL AND ALL WARNINGS CAREFULLY.

Failure to read, understand, and follow the instructions and warnings in this manual may result in **serious injury, death, and/or property damage.**

- Learn and obey all federal, state, and local firearm laws and regulations. These laws may vary by location.
- Do not provide this firearm to any person who is prohibited from owning firearms or who may use it for unlawful purposes.
- If you are unfamiliar with firearms, seek **formal firearms training** before use.

⚠ WARNING – CHILD SAFETY

Children are attracted to and can operate firearms, which can result in **severe injury or death.**

- Always keep firearms **unloaded and locked** when not in use.
- Prevent unauthorized access at all times.

- If a child gains access to a loaded firearm and uses it improperly, you may face **criminal penalties**.
 - **You can never be too careful.**
-

IMPORTANT LEGAL NOTICE

This firearm, as sold by Tippmann Ordnance, is a firearm. Any modification to the configuration of this firearm by the end user **may subject it to reclassification** under the **National Firearms Act (NFA)**, which may impose registration, taxation, and other legal requirements.

It is your responsibility to comply with **all federal, state, and local laws** regarding firearm ownership, possession, modification, and the installation of aftermarket accessories.

SAFE STORAGE & TRANSPORTATION

Safe and secure storage of your firearm is **your responsibility** and one of the most important rules of firearm safety.

- Always store firearms **unloaded and locked**.
- Store firearms and ammunition **separately**.
- Prevent access by children and unauthorized persons at all times.
- Never assume a single locking device is sufficient.
- Mechanical devices can be defeated given time and opportunity.

You are solely responsible for selecting and using appropriate storage methods to ensure your firearm is secure at all times.

TEN RULES FOR FIREARM SAFETY

1. Always keep the muzzle pointed in a safe direction.

Never point your firearm at anything you do not intend to shoot.

2. Unload your firearm when not in use.

Removing the magazine does not necessarily

unload the firearm. Always visually verify the chamber is empty.

3. Know your target and what is beyond it.

Bullets can travel great distances and may ricochet.

4. Use only the correct ammunition.

Using improper ammunition can cause serious injury or death.

5. If the firearm fails to fire, handle it with care.

Keep the muzzle pointed in a safe direction and wait before clearing.

6. Always wear eye and ear protection when shooting.

7. Ensure the barrel is clear of obstructions before firing.

8. Do not alter or modify your firearm.

Unauthorized modifications can be dangerous and illegal.

9. Clean and maintain your firearm regularly.

10. Learn the mechanical operation of your firearm.

Read this manual fully before use.

LEAD EXPOSURE WARNING

Discharging firearms, cleaning firearms, or handling ammunition may expose you to **lead**, a substance known to cause birth defects, reproductive harm, cancer, and other serious injury.

- Ensure adequate ventilation.
 - Wash hands thoroughly after handling firearms or ammunition.
-

SHOOT SOBER

Firearms and alcohol or drugs are a deadly combination.

Never use a firearm while impaired.

Failure to follow firearm safety rules may result in serious injury or death.

Step 1 - Remove the Lid Screw

Purpose

The lid screw must be removed before the belt-fed lid can be opened.

The lid cannot be opened with this screw installed.



Procedure

- 1. Locate the lid screw at the top of the receiver (see reference image).**
 - 2. Remove the lid screw by hand.**
 - **The lid screw is hand-tight only.**
 - **No tools are required.**
 - 3. Allow the lid screw to hang loosely down on its chain**
-

NOTE

- **Do not use tools to remove the lid screw.**
- **If resistance is felt, stop and verify you are turning the screw in the correct direction.**
- **Do not attempt to open the lid until the lid screw has been fully removed.**

Step 2 – Remove the Magazine Tube / Lid

Purpose

Remove the magazine tube / lid.

Procedure

1. Confirm the firearm is unloaded and safe before beginning installation.
2. Place the firearm on a stable work surface.
3. Grasp the **magazine tube / lid** and **lift it upward to the open position.**
4. With the magazine tube / lid fully open, **slide it straight forward toward the barrels.**

5. Remove the magazine tube / lid and set it aside.



NOTE

- The magazine tube / lid should slide out smoothly once lifted to the open position.
- Do not force the magazine tube / lid. If resistance is felt, verify it is fully opened and aligned before sliding it out.

Step 3 – Remove the Two Upper Lid Mounting Screws

Purpose

Remove the two upper lid mounting screws opposite side of the crank handle shown in the photo to allow removal of the original lid assembly.

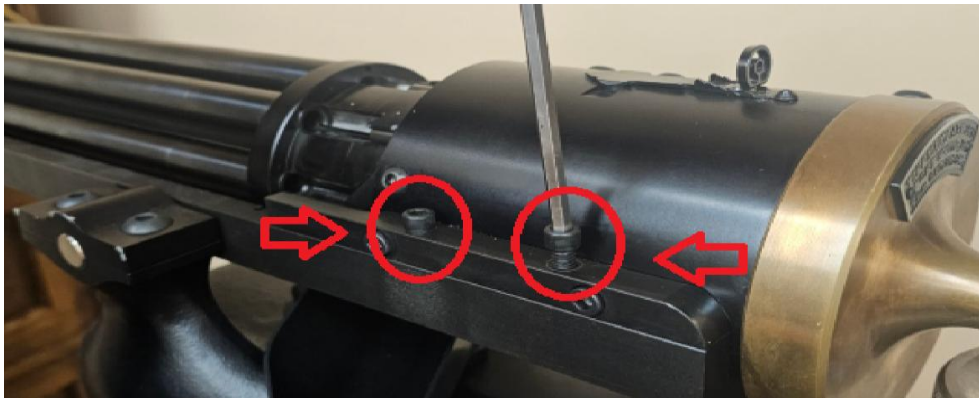

⚠ WARNING – Threadlocker will be present

All units have been assembled using high-strength threadlocker on the lid mounting screws. This may cause the screws to be difficult to remove.

Do not force the screws.

Excessive force may strip the screw head or damage the receiver.

If resistance is encountered, apply heat to the frame material surrounding the threaded area to soften the threadlocker before continuing.

If Heat Is Required

- **Use a heat gun (preferred) or a small propane torch (use with caution).**
- **Apply heat to the frame around the screw location, not directly to the screw head.**
- **Hold the heat source approximately 1 ½ inches away from the area.**
- **Apply heat for approximately 30 seconds to allow the threadlocker to release.**
- **Remove heat and immediately attempt to remove the screw using steady, controlled torque (see picture on next page).**
- **CAUTION AS PARTS MAY STILL BE HOT**



Step 4 - Remove the Two Lower Lid Mounting Screws

Purpose

Remove the two lower lid mounting screws shown in the photo to further release the original lid assembly.

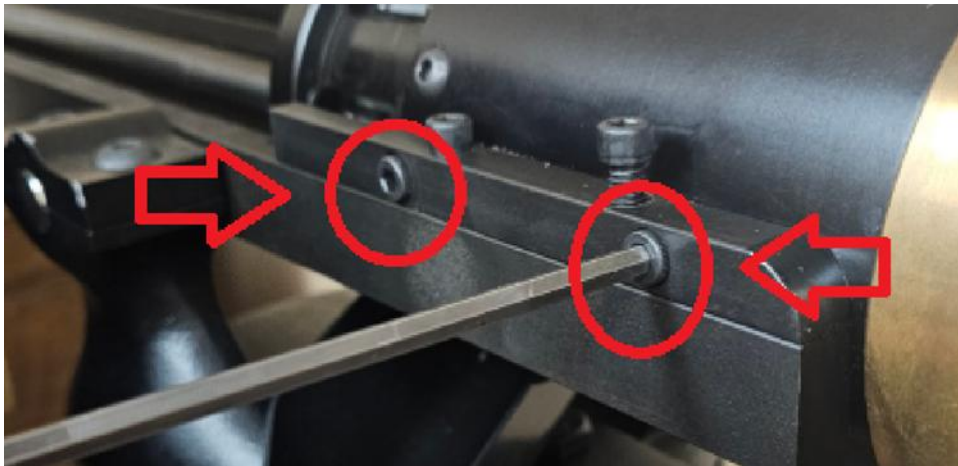

Procedure

- 1. With the firearm still unloaded and supported on a stable work surface, locate the two lower lid mounting screws identified in the photo.**
- 2. Using the supplied hex key, remove both screws.**
- 3. These screws should not be difficult to remove and are not typically installed with high-strength threadlocker.**

- 4. Discard the removed screws. New replacement screws are provided in the kit.**

Step 5 - Remove the Lid Rail

Purpose

Remove the lid rail to fully free the original lid assembly.



Procedure

- 1. Verify that all upper and lower lid mounting screws have been removed.**
 - 2. Locate the lid rail shown in the photo.**
 - 3. Lift the lid rail straight upward to disengage it from the receiver.**
 - 4. Remove the lid rail and set it aside.**
-

NOTE

- **The lid rail should lift off easily once all mounting screws are removed.**
- **Do not pry or force the lid rail. If resistance is felt, recheck that no screws remain installed.**

Step 6 – Identify the Belt-Fed Lid Assembly

Purpose

Identify the fully assembled belt-fed lid assembly included with the kit and verify proper orientation prior to installation.



Procedure

- 1. Remove the belt-fed lid assembly from the kit packaging.**
- 2. Verify the assembly is fully assembled and matches the configuration shown in the reference photo.**
- 3. Confirm the following before installation:**
 - The curved lid section faces upward.**
 - The lid rail is securely attached to the underside of the lid.**
 - All mounting holes in the lid rail are clear and undamaged.**

NOTE

- The belt-fed lid assembly is fully assembled from the factory.**
- No disassembly or modification of the belt-fed lid assembly is required before installation.**
- Do not attempt to separate components of the belt-fed lid assembly.**

Step 7 - Install the Belt-Fed Lid Assembly (Top Mounting Screws)

Purpose

Secure the belt-fed lid assembly to the receiver using the two supplied top mounting screws for the left side rails and the mounting screw on the right side mounting hole.



Procedure

- 1. Position the belt-fed lid assembly onto the receiver, aligning the lid rail with the mounting surface.**
- 2. Locate the two top mounting holes on the lid rail, as shown in the reference image.**
- 3. Install the two new mounting screws provided in the kit into the top mounting holes by hand.**

- 4. Insert the supplied mounting screw into the right-side mounting hole.**
 - 5. Using the provided hex key, tighten the screw until the belt-fed lid is firmly secured.**
 - 6. Using the supplied hex key, tighten the screws evenly until snug.**
-

NOTE

- Only use the new screws supplied with the kit.**
 - The original screws removed during disassembly may be discarded.**
 - Do not fully torque one screw before the other—alternate between screws to ensure proper alignment.**
-

CAUTION

- Do not overtighten. Excessive torque may damage the receiver or mounting threads.**

Step 8 – Install the Lower Lid Rail Screws

Purpose

Secure the lower portion of the belt-fed lid assembly to the receiver.

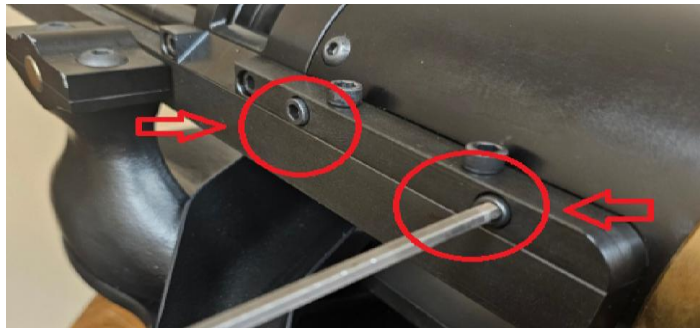

Procedure

- 1. With the two top mounting screws already installed and snug, locate the lower mounting holes in the lid rail, as shown in the reference image.**
 - 2. Insert the remaining lower mounting screws provided in the kit into the lid rail and receiver.**
 - 3. Start each screw by hand to ensure proper thread engagement.**
 - 4. Using the supplied hex key, tighten the lower screws evenly until snug.**
-

NOTE

- **The lower screws should install smoothly without excessive resistance.**
 - **If resistance is encountered, stop and verify the lid rail is properly aligned before continuing.**
-

CAUTION

- **Do not overtighten. Excessive torque may damage the receiver or mounting threads.**

Step 9 – Load Ammunition Into the Belt

Purpose

Prepare the belt for feeding by correctly installing ammunition in the proper orientation.





Procedure

- 1. Identify the leading end of the belt with the hook. This is the end that feeds into the gun.**
- 2. Hold the belt so the hooked end is facing forward, toward the muzzle end of the firearm.**
- 3. Insert each cartridge into the belt by pressing it fully into the belt links until it is seated securely.**
- 4. Continue loading cartridges into the belt, ensuring consistent orientation for all rounds.**

IMPORTANT

- Always load the belt starting from the hooked end.**

- **Installing ammunition from the incorrect end may cause feeding issues or prevent the belt from properly engaging the feed mechanism.**
-

NOTE

- **Cartridges should seat firmly into the belt without excessive force.**
- **If a round does not seat easily, verify alignment and orientation before continuing.**

Final Step – Operate the Firearm

Purpose

Begin normal operation after the belt-fed system has been properly installed and loaded.



Procedure

- 1. Confirm the ammunition belt is properly seated in the feed slot.**
- 2. Ensure the firearm is pointed in a safe direction.**
- 3. Using the operating handle, rotate the handle clockwise to initiate the firing mechanism.**

WARNING

- Always follow all firearm safety rules.**
- Keep the firearm pointed in a safe direction at all times.**
- Keep hands, fingers, and loose clothing clear of all moving parts during operation.**
- Use only ammunition specified by the manufacturer.**

NOTE

If the firearm does not operate as expected, stop immediately, clear the firearm, and inspect the belt before continuing.

CONTACT INFORMATION

If you have questions regarding the safe use of this firearm, contact:

Tippmann Ordnance – Customer Service

2955 South Maplecrest Road

Fort Wayne, IN 46803

 800-671-1498

 www.TippmannOrdnance.com

